

# CORNER RECORD

Agency Index

Document Number

City of AMERICAN CANYON

County of NAPA, California

## Brief Legal Description

CITY MONUMENT AS SHOWN UPON MAP No. 5412 (23 RM 25-36) ALONG WETLANDS EDGE ROAD  
WEST OF 31 BLUEBELL STREET (APN 058-601-001)

## CORNER TYPE

## COORDINATES (Optional)

SECTION 23  
T.4 N.  
R.4 W.  
M.D.M.Government Corner ☐ Control  
Meander ☐ Property  
Rancho ☐ OtherN. \_\_\_\_\_ E. \_\_\_\_\_  
☒ Elevation \_\_\_\_\_  
☐ Units Metric ☐ U.S. Survey Foot ☒  
☐ Horizontal Datum \_\_\_\_\_  
Zone \_\_\_\_\_ Epoch Date \_\_\_\_\_  
Vertical Datum \_\_\_\_\_

Date of Survey 5/15/2020

☐ Complies with Public Resources Code §§8801-8819  
☐ Complies with Public Resources Code §§8890-8902PLS Act Ref: ☐ 8765(d) ☒ 8771 ☐ 8773 ☐ Other:  
Corner/  
Monument: ☒ Left as found ☐ Established ☐ Rebuilt ☒ Pre-Construction  
☐ Found and tagged ☐ Reestablished ☒ Referenced ☐ Post-Construction

Narrative of corner identified and monument as found, set, reset, replaced, or removed:

☒ See sheet #2 for description (s):FOUND MONUMENT THAT COULD BE DAMAGED OR DESTROYED BY A PROPOSED ELECTRIC UNDERGROUND CONSTRUCTION PROJECT.  
MONUMENT WAS REFERENCED AS SHOWN ON PAGE 2 OF 2.THE PURPOSE OF THIS CORNER RECORD IS TO PRESERVE THE LOCATION OF THE MONUMENT PRIOR TO CONSTRUCTION. NO  
ATTEMPT WAS MADE TO DETERMINE THE RELATIONSHIP BETWEEN THE MONUMENT AND BOUNDARY LINES.

## SURVEYOR'S STATEMENT

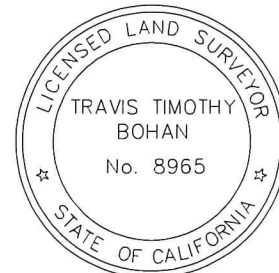
This Corner Record was prepared by me or under my direction in conformance with  
the Professional Land Surveyors' Act on JUNE 18, 2020Signed Travis Timothy Bohan P.L.S. or R.C.E. No. 8965

## COUNTY SURVEYOR'S STATEMENT

This Corner Record was received MAY 28, 2020  
and examined and filed MARCH 28, 2020Signed Danielle L. Goshert P.L.S. or R.C.E. No. 8491Title COUNTY SURVEYOR

County Surveyor's Comment \_\_\_\_\_

CC-19103\_016

**MARK  
THOMAS**

APN 058-020-017

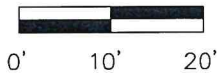

SCALE: 1" = 20'

**BASIS OF BEARING:**

BEARING BASIS IS ASSUMED

**LEGEND:**

- FOUND 2.5" DISK IN WELL STAMPED RCE 25281
- ⊙ SET RIVET WITH REF PT BRASS TAG LS 8965 IN TOP OF CURB
- FC FACE OF CURB
- SD STORM DRAIN MANHOLE
- VLT ELECTRICAL VAULT

APN 058-040-042  
22 RM 34-41WETLANDS EDGE ROAD  
(WIDTH VARIES)

23 RM 25-36

31 BLUEBELL STREET  
APN 058-601-001

23 RM 53-61