

# CORNER RECORD

Agency Index

BK 116 PG 54

Document Number

CR 12150

City of EDEN TOWNSHIP

County of ALAMEDA, California

Brief Legal Description WELL MONUMENT LOCATED WITHIN 153RD AVE  
AT THE INTERSECTION OF E 14TH ST

## CORNER TYPE

## COORDINATES (Optional)

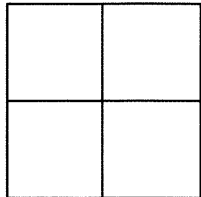

Government Corner	<input type="checkbox"/>	Control	<input checked="" type="checkbox"/>
Meander	<input type="checkbox"/>	Property	<input type="checkbox"/>
Rancho	<input type="checkbox"/>	Other	<input type="checkbox"/>

N. 2082858 ± E. 6091179 ±

Elevation

Units Metric ☐ U.S. Survey Foot ☐

Horizontal Datum

Zone Epoch Date

Vertical Datum

☐ Complies with Public Resources Code §§8801-8819☐ Complies with Public Resources Code §§8890-8902PLS Act Ref: ☐ 8765(d)☒ 8771☐ 8773☐ Other:Corner/Monument: ☒ Left as found☐ Established☐ Rebuilt☐ Pre-Construction☐ Found and tagged☐ Reestablished☐ Referenced☒ Post-Construction

Narrative of corner identified and monument as found, set, reset, replaced, or removed:

☐ See sheet #2 for description(s) : SEE CR 11645

FOUND MONUMENT WELL WITH NO CORE. REFERENCED LID.

FOUND AND SET POINTS AS SHOWN ON PAGE 2.

THIS POINT WAS FOUND IN SAME CONDITION AFTER A CONSTRUCTION PROJECT IN THE VICINITY.  
THE TIES SHOWN HEREON ARE FOR THE PURPOSE OF PERPETUATING FOUND MONUMENTATION.  
NO CLAIM IS MADE AS TO THE RELATIONSHIP OF THE POINTS OR LINES SHOWN HEREON TO TRUE  
BOUNDARY LOCATION.

## SURVEYOR'S STATEMENT

This Corner Record was prepared by me or under my direction in conformance with

the Professional Land Surveyors' Act on AUGUST 28, 2018.

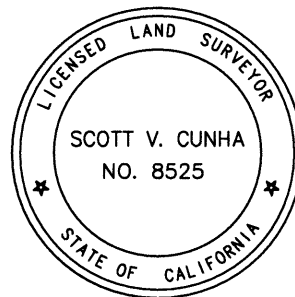
Signed Scott V. Cunha P.L.S. or R.C.E. No. LS 8525  
SCOTT V. CUNHA

## COUNTY SURVEYOR'S STATEMENT

This Corner Record was received 21 SEPTEMBER 2018

and examined and filed 11 DECEMBER 2018.

Signed Michael Rubner P.L.S. or R.C.E. No. 6843

Title COUNTY SURVEYOR



County Surveyor's Comment



SPEC-2356-POST

SCALE: 1"=30'

## LEGEND

-  FOUND MONUMENT WELL WITH NO CORE
-  FOUND CUT CROSS IN WALK
-  FOUND CUT CROSS IN CURB
- AA##A# ALAMEDA COUNTY MONUMENT ID
- 19592 REFERENCE STREET ADDRESS

