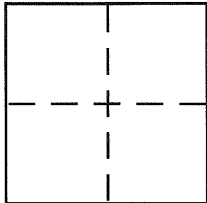

**CORNER RECORD**Document Number CR 1576City of OAKLANDCounty of ALAMEDA, CaliforniaBrief Legal Description NORTHEAST LINE OF LOT 21, TRACT 517 (14 M. 47)**CORNER TYPE**

Government Corner ☐ Control ☐  
 Meander ☐ Property ☒  
 Rancho ☐ Other ☐  
 Date of Survey \_\_\_\_\_

**COORDINATES (Optional)**

N. \_\_\_\_\_  
 E. \_\_\_\_\_  
 Zone \_\_\_\_\_ NAD27 ☐ NAD83 ☐  
 NAD83 Epoch \_\_\_\_\_  
 Elev. \_\_\_\_\_  
 Vert. Datum: NGVD29 ☐ NAVD88 ☐  
 Meas. Units: Metric ☐ Imperial ☐

Corner – Left as found ☐ Found and tagged ☐ Established ☐ Reestablished ☒ Rebuilt ☐

Identification and type of corner found: Evidence used to identify or procedure used to establish or reestablish the corner:

⊙ Found standard city well monument with 1/4" nail in concrete.

A description of the physical condition of the monument as found and as set or reset:

○ set 5/8" rebar with plastic cap "FOSTER L.S. 7170"  
☒ set 2"x2" wood hub with brass tag "L.S. 7170"

**SURVEYOR'S STATEMENT**

This Corner Record was prepared by me or under my direction in conformance with the Land Surveyor's Act on September 18, 2001

Signed Michael J. Foster P.L.S. or R.C.E. No. L.S. 7170

**COUNTY SURVEYOR'S STATEMENT**

This Corner Record was received \_\_\_\_\_

and examined and filed 1-04-2007

Signed Russell R. Penland, Jr. P.L.S. or R.C.E. No. 5726

Title County Surveyor

County Surveyor's Comment \_\_\_\_\_

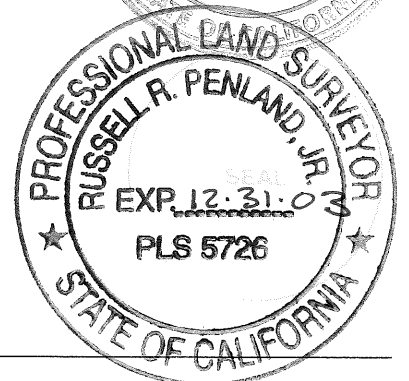
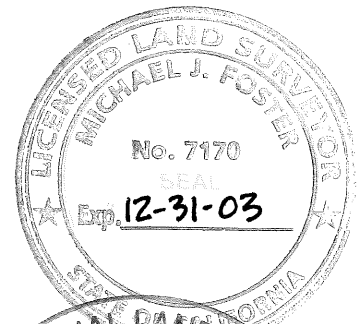

S 33°32'00" W 91.00'

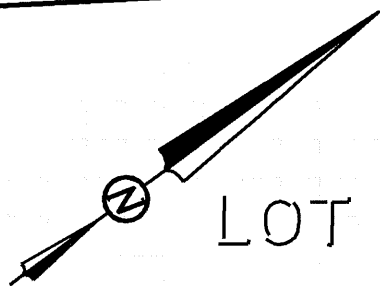

LOT 21

LOT 20

LEGEND	
⊙	FOUND CITY MONUMENT
○	SET REBAR & CAP, L.S. 7170
⊠	SET HUB & TAG, L.S. 7170
( )	RECORD DATA

78.91'  
123.06'

44.15'  
N 41°53'00" W

L=18.88'  
R=130.00'

R=130'

L=69.61'

D=30°40'44"

N 51°25'00" W  
(RADIAL)

N 43°05'44" W  
(RADIAL)

S 81°31'10" E  
33.10'

N 77°35'00" E  
35.41'

N 12°25'00" W (R)  
30.00'

LA SALLE AVENUE  
N 27°14'50" E 96.29' (50' WIDE)  
(96.19')

# CORNER RECORD

NORTHEAST LINE OF LOT 21, TRACT 517 (14 M. 47)  
OAKLAND, ALAMEDA COUNTY, CALIFORNIA  
OCTOBER, 2001 SCALE 1" = 20'

## BAY AREA LAND SURVEYING

1828 BONITA ROAD  
RICHMOND, CA 94806  
(510) 232-3095

A.P.N. 048C-7179-039-07 SHT. 1 OF 1 F.B #52 /LASALLE366 JOB NO. 01-366