



BRITT, PETERS
— AND —
ASSOCIATES
— INC. —
consulting engineers
999 Waterside Drive
Suite 2202
Norfolk, VA 23510
(757) 956-5710
www.brittspeters.com
BPA Project No. 220653
NC COA# C-1088

NRD
national
restaurant
designers

phone: 919.544.0087 fax: 919.544.9399

A Division of LMHT Associates

A Division of LMHT Associates

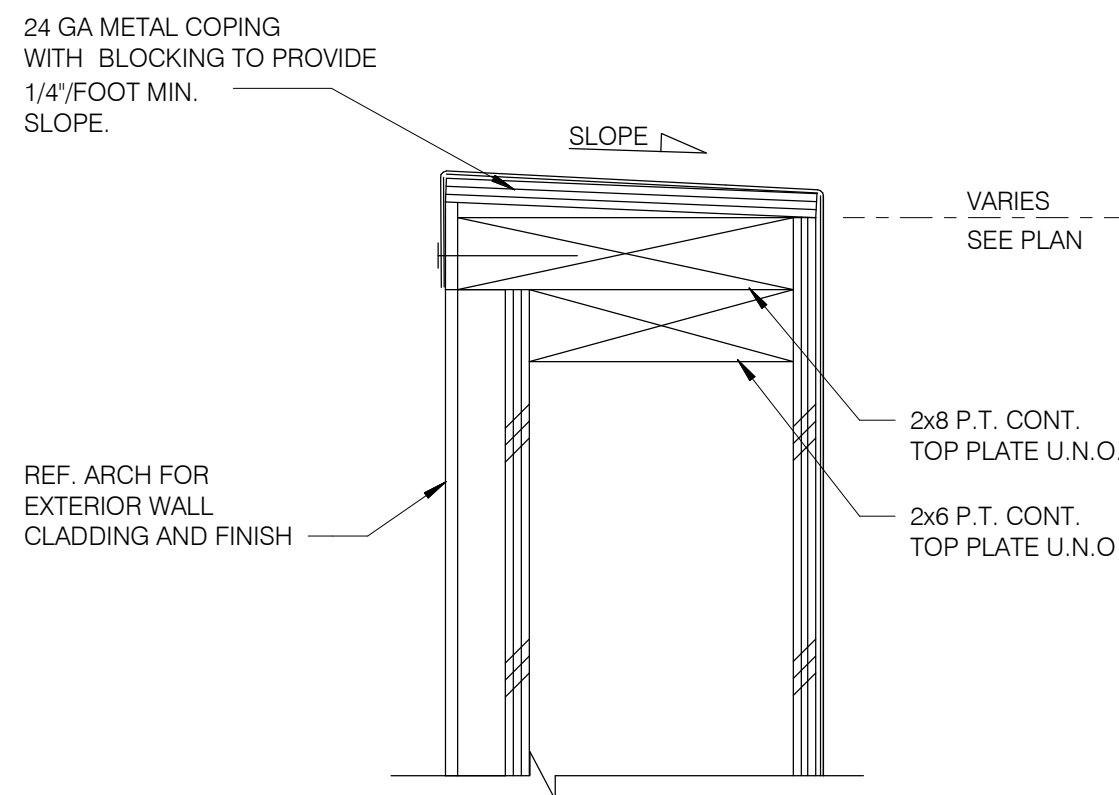

TYPICAL PARAPET CAP NO SCALE **1**

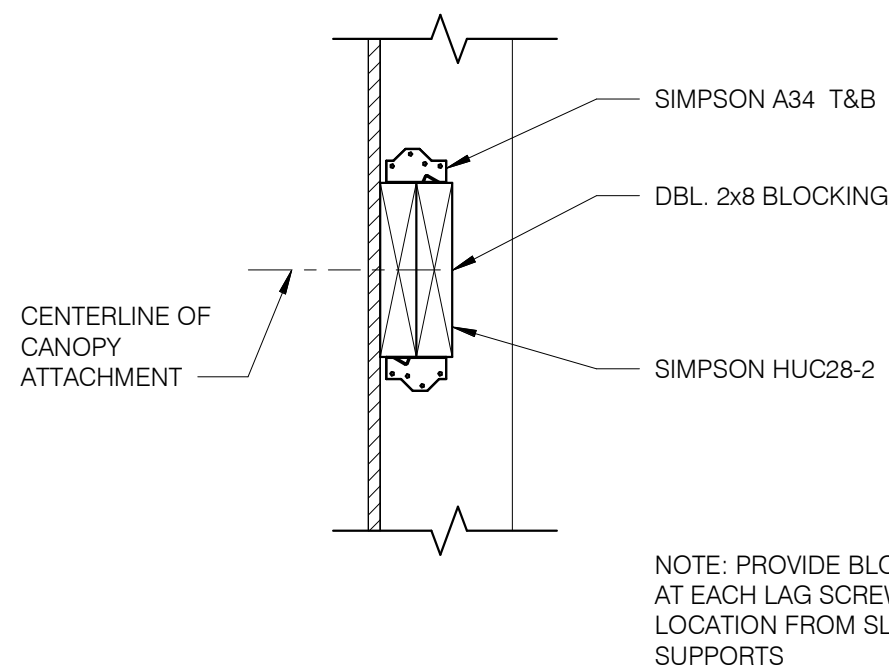

SIGNAGE ATTACHMENT BLOCKING DETAIL NO SCALE **2**

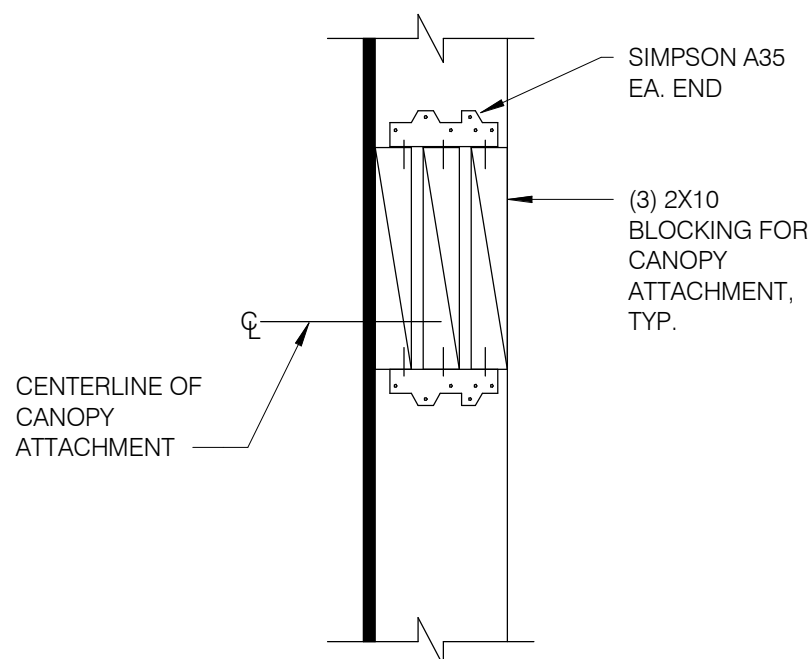

CANOPY TIE BACK BLOCKING DETAIL NO SCALE **3**

[illegible]

CONTRACT DATE:	06/03/2022
BUILDING TYPE:	END. MED 40
PLAN VERSION:	SEPT. 2021
BRAND DESIGNER:	
SITE NUMBER:	315870
ENTITY NUMBER:	
PA/PM:	DRA
DRAWN BY.:	DES
JOB NO.:	22653

ENDEAVOR 2.0
5116 NC 87 South
Fayetteville, NC 28306



ENDEAVOR 2.0

FRAMING DETAILS

S4.3

PLOT DATE: 6/6/2022 1:45:41 PM