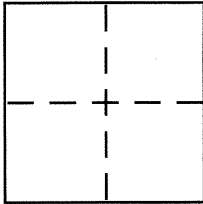

CORNER RECORDDocument Number CR 8493City of FREMONTCounty of ALAMEDA, CaliforniaBrief Legal Description LOT 13, TRACT 3756, FILED IN BOOK 95 OF MAPS, AT PAGE 53**CORNER TYPE**

Government Corner . Control .
 Meander . Property **X**
 Rancho . Other .
 Date of Survey MAY 28, 2016

COORDINATES (Optional)

N. _____
 E. _____
 Zone _____ NAD27 . NAD83 .
 NAD83 Epoch _____
 Elev. _____
 Vert. Datum: NGVD29 . NAVD88 .
 Meas. Units: Metric . Imperial .

Corner – Left as found . Found and tagged . Established **X** Reestablished . Rebuilt .

Identification and type of corner found: Evidence used to identify or procedure used to establish or reestablish the corner:
FOUND: 2.5" DIAMETER BRASS DISCS & PUNCH IN MONUMENT WELLS IN SIOUX COURT, AS SHOWN ON
TRACT 3756, PER BOOK 95 MAPS, PAGE 53.

SEE SKETCH ON PAGE 2 OF 2

A description of the physical condition of the monument as found and as set or reset: _____

SET: NAIL WITH 3/4" BRASS TAG "PLS 7393" IN TOP OF 4X4 FENCE POST, AND 1/2" DIAMETER REBAR
& PLASTIC CAP "PLS 7393".

SEE SKETCH ON PAGE 2 OF 2

SURVEYOR'S STATEMENT

This Corner Record was prepared by me or under my direction in conformance with
 the Land Surveyor's Act on JUNE 08 2016

Signed K. Nofield P.L.S. or P.C.E. No. PLS 7393

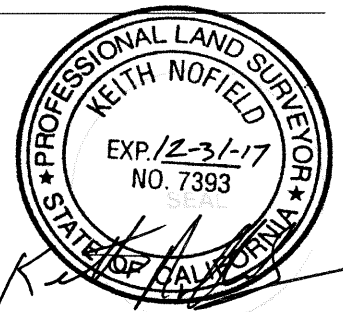
**COUNTY SURVEYOR'S STATEMENT**

This Corner Record was received 14 JUNE, 2016
 and examined and filed 30 JUNE, 2016

Signed Michael Rubner P.L.S. or P.C.E. No. 6843

Title COUNTY SURVEYOR

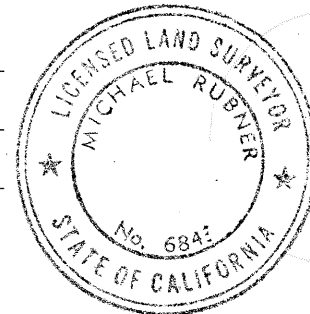

County Surveyor's Comment _____

SCALE IN FEET



SCALE: 1"=50'



S 72°09'24" W 425.15' (M-M)

SIoux COURT (52' WIDE)

PARKMEADOW DRIVE

N 21°00'34" W 253.52'

LOT 13
TRACT 3756
95 MAPS 53
APN: 519-1660-007

LANDS OF CITY &
COUNTY OF SAN FRANCISCO
APN: 519-1660-006

SIoux COURT

S 40°32'19" E 888.98' (M-M)

N 121°18' 76°26'26" W

LOT 19
95 M 53

N 17°50'36" W 209.12'

LOT 14
95 M 53

R=174.00'
D=27°07'07"
L=82.36'
N 9°16'31" E (R)
10.11'

LEGEND

- FOUND 2 1/2" DIAMETER BRASS DISC WITH PUNCH IN MONUMENT WELL, STAMPED "RE 10879" PER (95 M 53)
- △ SET NAIL & 3/4" DIAMETER BRASS TAG "PLS 7393"
- SET 1/2" DIAMETER REBAR & PLASTIC CAP "PLS 7393"
- (R) RADIAL
- (M-M) MONUMENT TO MONUMENT

(JOB NO. 16-049)