

# CORNER RECORD

98-033 7 Cr 011

APN No. \_\_\_\_\_ - \_\_\_\_\_ - \_\_\_\_\_ (Optional) Document Number CR 927  
 City of ALBANY County of ALAMEDA, California  
 Brief Legal Description MONUMENT AT NORTHEAST CORNER OF THE INTERSECTION OF STANNAGE AVE. AND BRIGHTON AVE.

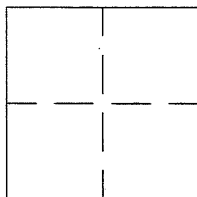

## CORNER TYPE

Government Corner ☐ Control ☐  
 Meander ☐ Property ☐  
 Rancho ☐ Other ☒  
 Date of Survey 5/9/97

## COORDINATES (Optional)

N. \_\_\_\_\_  
 E. \_\_\_\_\_  
 Zone \_\_\_\_\_ Datum \_\_\_\_\_  
 Elev. \_\_\_\_\_

Corner - Left as found ☐ Found and tagged ☐ Established ☐ Reestablished ☒ Rebuilt ☐

In compliance with Section 8771 of the Professional Land Surveyors' Act, this corner record is being filed to ESTABLISH \_\_\_\_\_ / REESTABLISH ☒ the position of an existing monument PRIOR \_\_\_\_\_ / SUBSEQUENT ☒ to street or highway reconstruction. (Use this portion only when applicable.)

Identification and type of corner found: Evidence used to identify or procedure used to establish or reestablish the corner:  
BRASS DISK IN CYLINDER IN SIDEWALK

A description of the physical condition of the monument as found and as set or reset: MONUMENT WAS REFERENCED; CITY CONTRACTOR REMOVED CONCRETE SIDEWALK, CONSTRUCTED NEW PCC CURB RAMP AND RESET CYLINDER; EXISTING DISK WAS RESET IN MORTAR IN CYLINDER.

## SURVEYOR'S STATEMENT

This Corner Record was prepared by me or under my direction in conformance with the Land Surveyors' Act on OCTOBER 14, 19 97.

Signed John W. Poore Sr. L.S. or R.C.E. Number RCE 17501

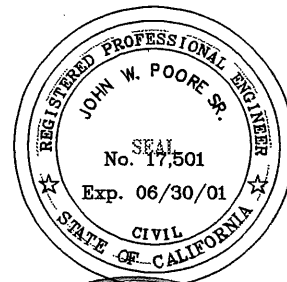

## COUNTY SURVEYOR'S STATEMENT

This Corner Record was received 11-13 19 97 and examined and filed 5-13 19 98

Signed Russell R. Penland, Jr. Title Deputy County Surveyor

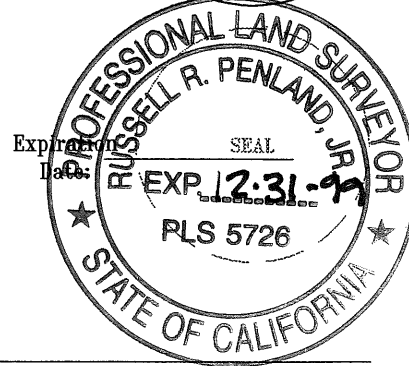

County Surveyor's Comment \_\_\_\_\_  
 \_\_\_\_\_  
 \_\_\_\_\_

STANNAGE AVENUE

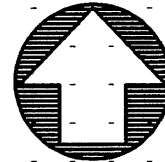

SCALE: 1"=10'

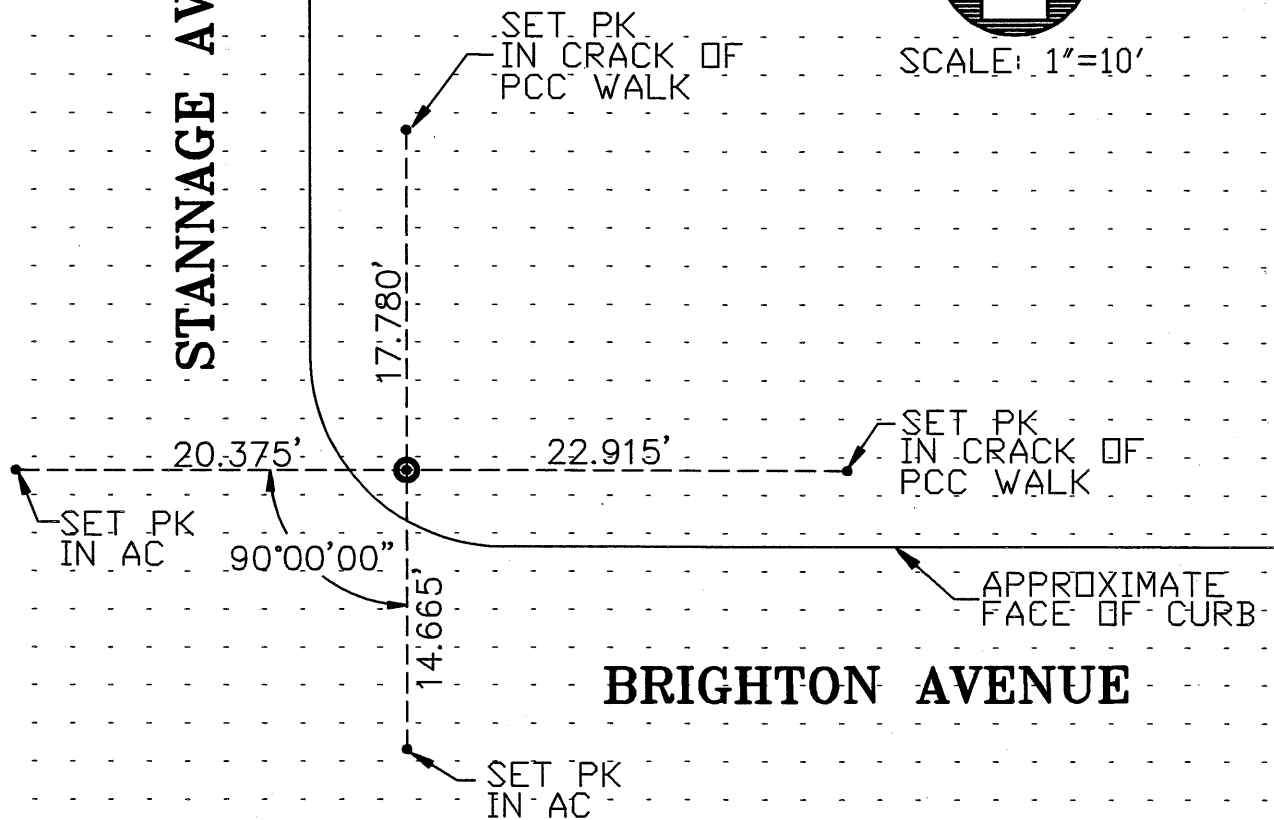

LEGEND

- FACE OF CURB
- RESET EXISTING MONUMENT IN NEW CURB RAMP
- SET PK NAIL (AS NOTED)
- AC ASPHALT CONCRETE
- PCC PORTLAND CEMENT CONCRETE